

CONFIDENTIAL - NOT TO BE DISCLOSED

A2 (694x420)

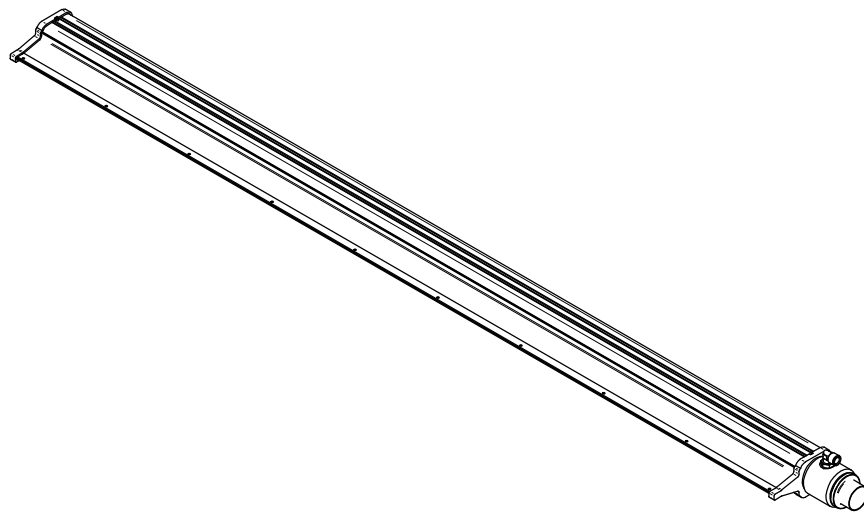
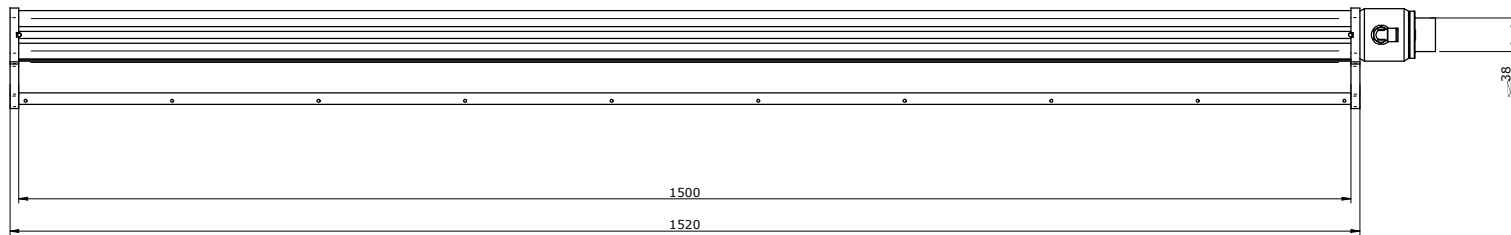
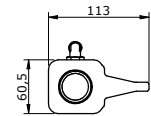
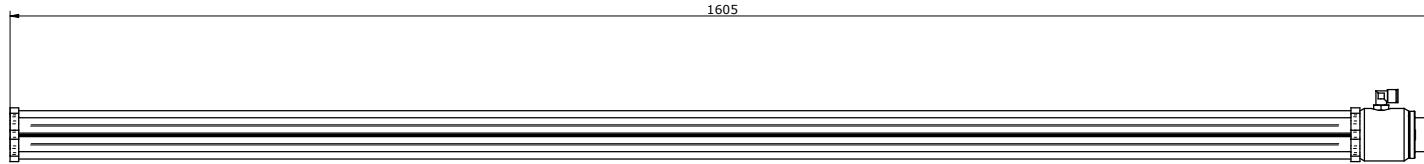
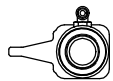

FILETTATURE / THREADS 6H / 6g	TOLLERANZE/GENERAL TOLERANCES - UNI EN22768-2-FH					
SMUSSI / CHAMFERS 0.3 x 45° MAX	LINEAR DIMENSIONS		ANGULAR DIMENSIONS		[]	
	0.5 - 6	6 - 30	30 - 100	100 - 400	0 - 10	10 - 50
	±0.05	±0.10	±0.15	±0.20	±1°	±0°'30" / ±0°'20"
MATERIALE / MATERIAL						
TRATT. TERMICO/ HEAT TREATMENT				DATA/DATE		
-				04/12/2018		
TRATT. SUPERFICIALE/SURFACE TREATMENT				AUTORE/AUT/PRO		
-				L.Lombardi		
DESCRIZIONE / DESCRIPTION				PESO/WEIGHT		SCALARE/SCALE
LAMA D'ARIA CON AMPLIFICATORE AM/30T				0.000 kg		12
simianproject.com				CODICE/COE		REV.
				90ABX 1500 AM30-T		00